

PRODUCT DATASHEET

High light efficiency Recessed Down light
HYD-219C-30W 4000K



Application

- Hotel
- Mall
- Lobby
- Theater
- Airport

Benefits

- Flicker free.
- Low lumen depreciation.
- Minimum Glare, more clear and comfortable
- White inner cup, improve light efficiency, increase brightness

Features

- Die-cast aluminum body for better heat dissipation, anti-corrosion, and easy maintain
- Yellowing-resistant diffuser (PC)
- Buckle design, easy and quick installation
- Warranty 5 years

Electrical Data

Nominal wattage (W)	30 W
Nominal Voltage (V)	220-240 V
Mains Frequency (Hz)	50
Nominal Current (mA)	134
LED Driver Current (mA)	750
LED Driver Voltage (V)	24-42
LED Driver Efficiency (%)	87%
Power Factor λ	0.95
Total harmonic distortion (%)	...
Operating mode	External LED driver

Photometrical data

Luminous flux $\pm 10\%$ (lm)	3709 lm
Luminous efficacy	133 lm/w
Color temperature	4000K
Light color (designation)	Nature White
Color rendering index Ra	≥ 80
Standard deviation of color matching	≤ 5 SDCM
Luminous intensity/cd	2045
Flickering	Flicker free
Beam angle	84 °

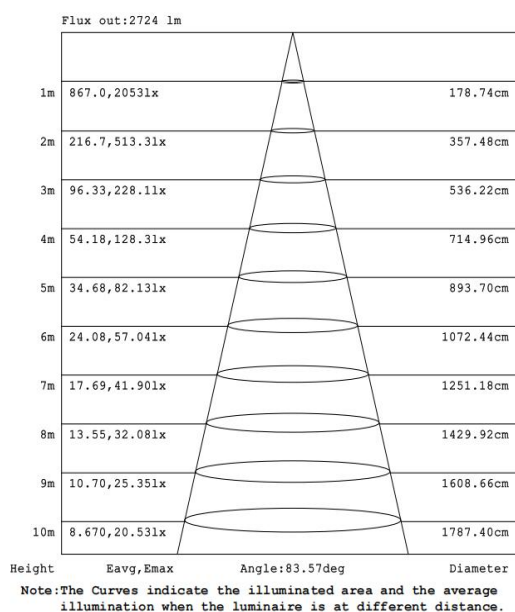
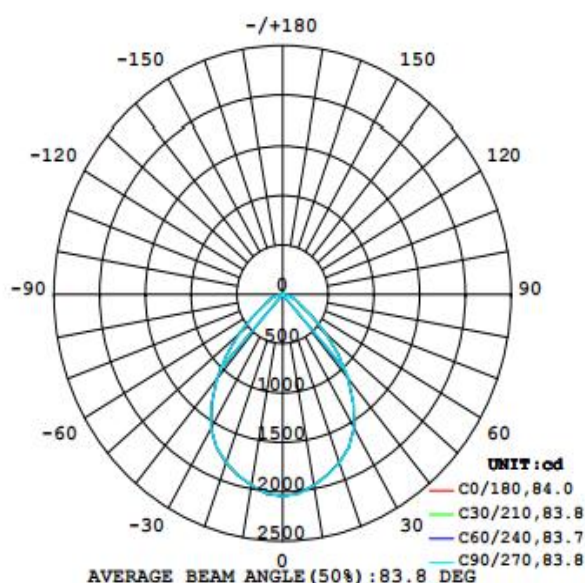

Dimensions & Weight

Diameter (mm)	185
Height (mm)	95
Product weight (g)	...

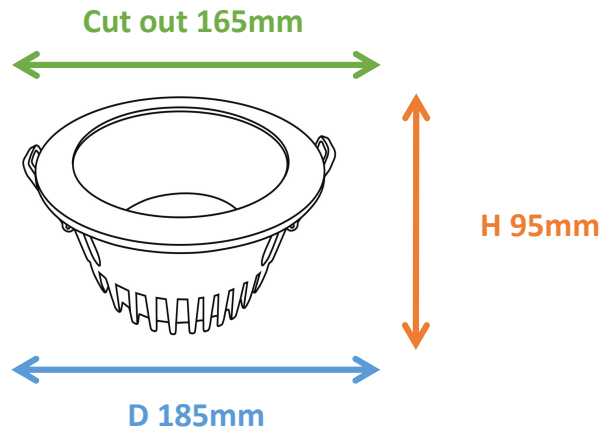

Material & Colors

Product color	White Lamp cup / Brown Housing
Housing color	Brown
Body material	Aluminum
Cover material	PC
Mercury content	0.0 mg

Application & Mounting

Ambient temperature range	-10°C~+40 °C
Temperature range at storage	-10°C~+40 °C
Type of connection	Screwless terminal
Type of protection	IP20
Dimmable	No
Mounting type	Recessed mounted
Mounting location	Ceiling
Application environment	Indoor
Cut size (mm)	165
LED module replaceable	Not replaceable
With light source	Yes

Certificates & Lifespan

Life (h)	50,000
Certificates	CB LVD EMC RoHS
Standards	ISO9001:2015

Logistical Data

Product code	Dimensions (L*W*H)	Pcs/ carton	G.W. kg	Volume CBM
HYD-219C-30W	62*42*42.5 cm	20	...	0.11067

Installation Method

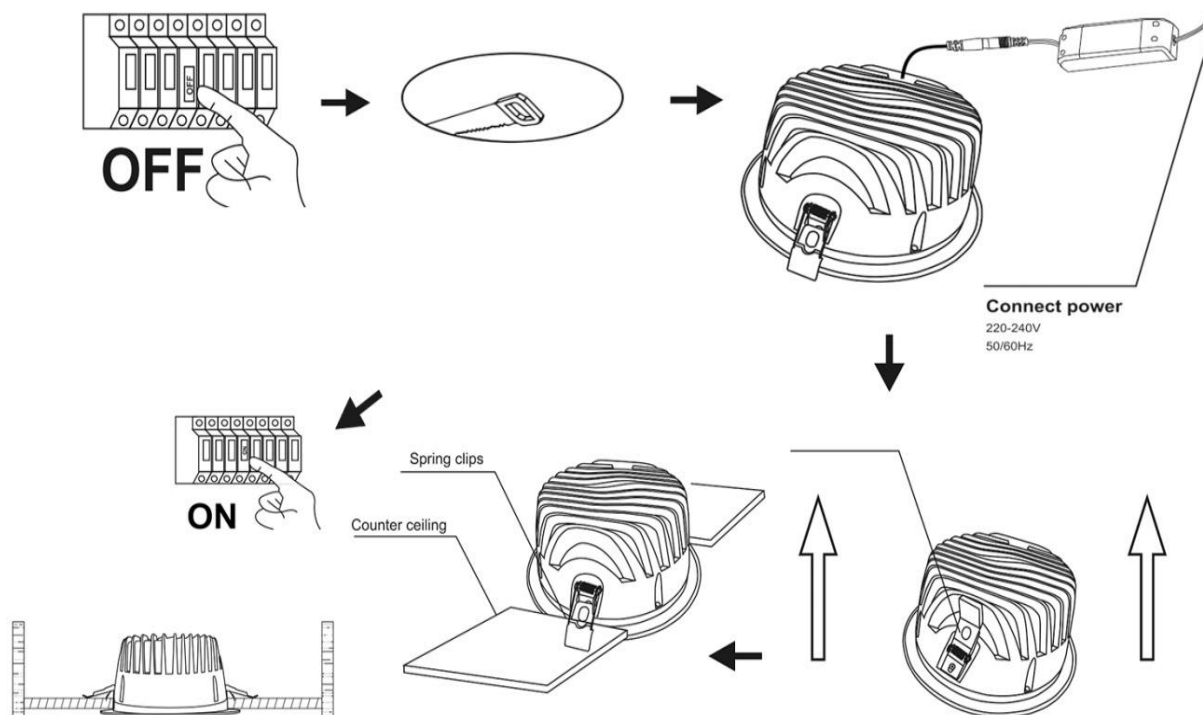

Disclaimer

Subject to change without notice. Errors and omission excepted. Always make sure to use the most recent release